

How to download the Members App for Apple Devices

This guide has been created to assist users in downloading the Mobile App on Apple devices. The images provided in this guide may appear slightly different depending on the model and size of your device.

Contents

1. Access the Mobile App Download Page.....	2
2. Download the App by selecting the App Store Button	3
3. Wait for the App to be installed.....	4
4. Untrusted Enterprise Developer	5
5. Access Device Settings	6
6. Select General	7
7. Select Device Management	8
8. Click Entire Software Pty Ltd.....	9
9. Final Step Trust “Entire Software Pty Ltd”	9

1. Access the Mobile App Download Page.

A link will be sent to you Via an email or SMS. Click on the link provided to be taken to the download page.

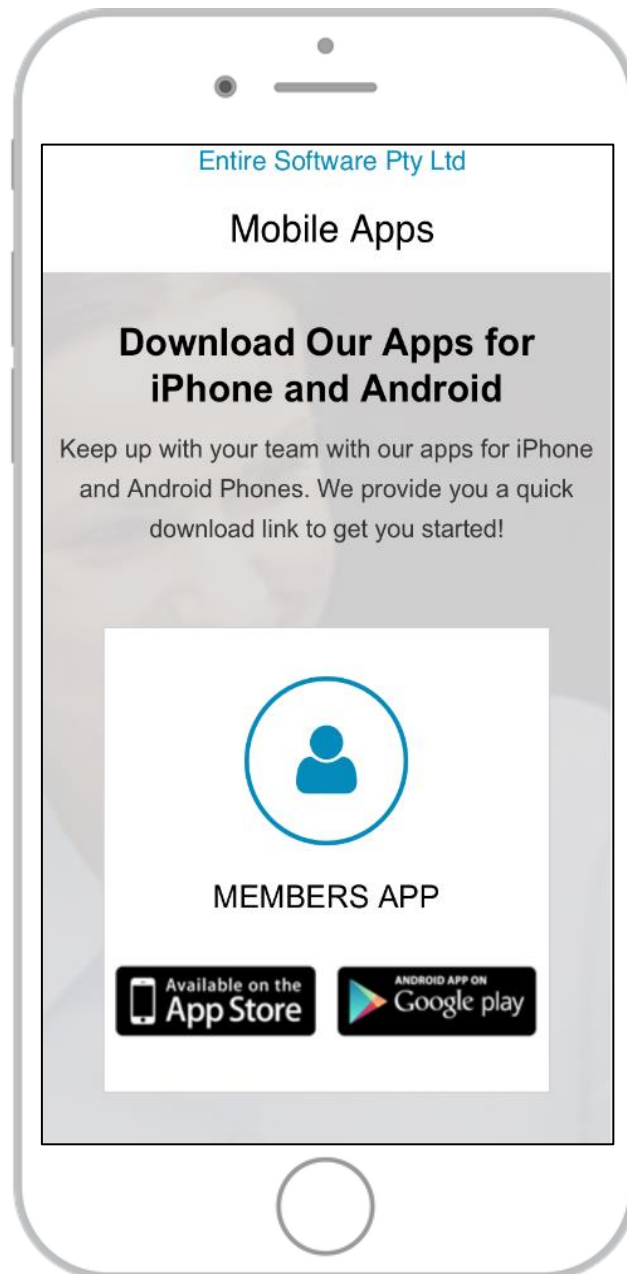

Note, if you have not received an email please contact the agency and request for this to be resent.

2. Download the App by selecting the App Store Button

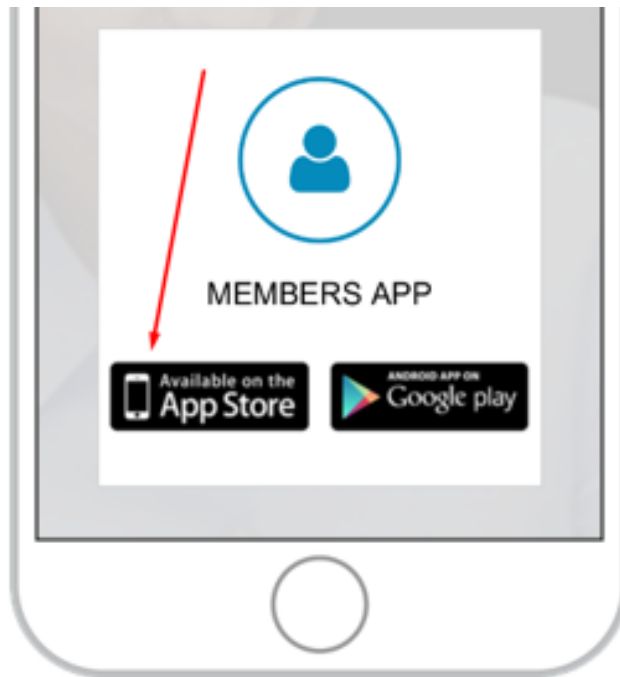

A pop-up message will appear. Click Install to directly download the App

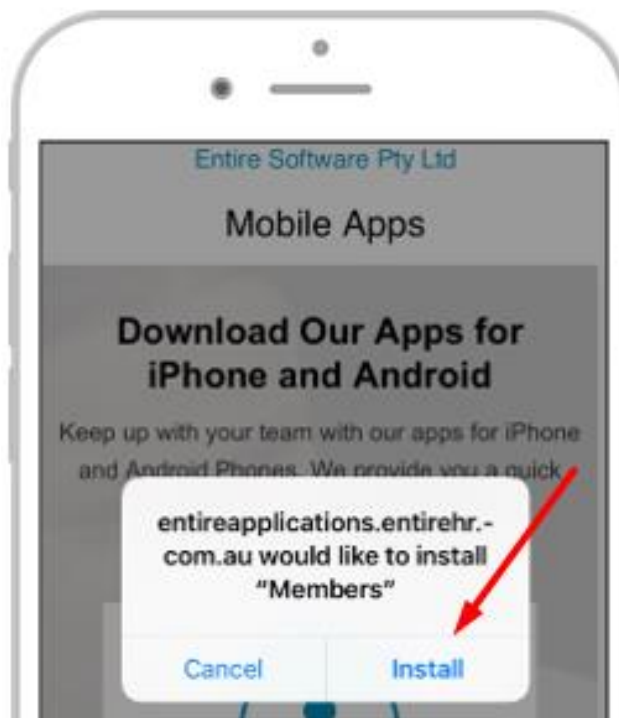

Once you have selected install the direct download will begin and you can exit the internet browser.

3. Wait for the App to be installed

Relax it won't take long for the App to install on your device.

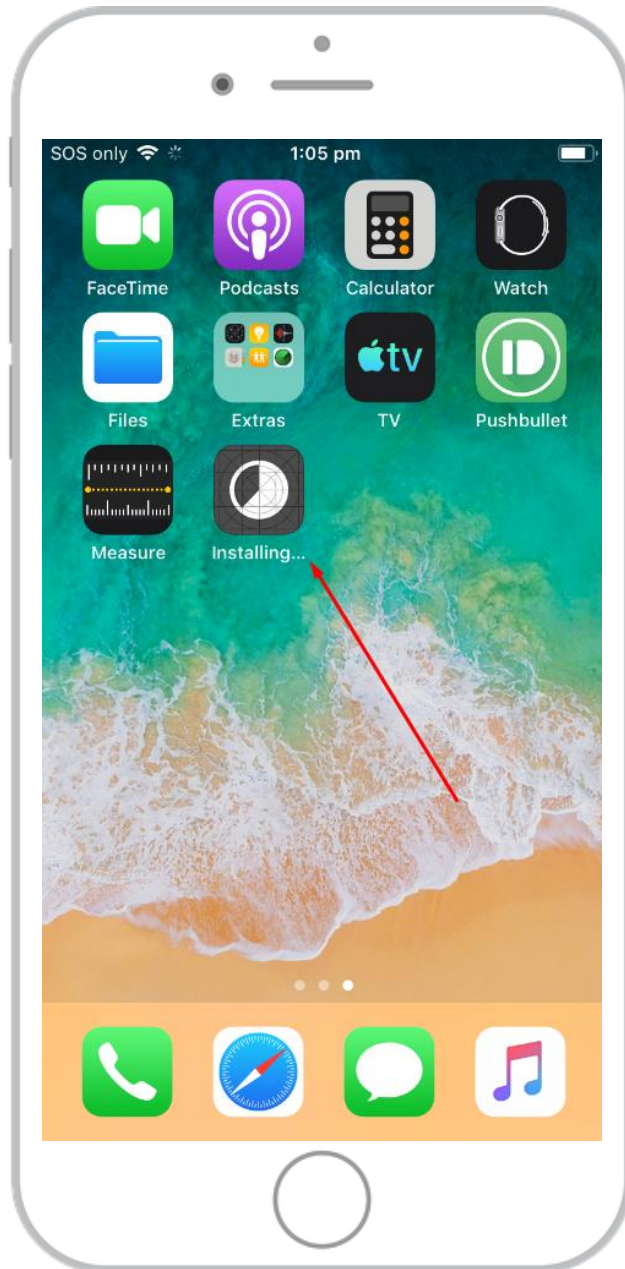

4. Untrusted Enterprise Developer

Once installed you are required to Trust the developer before gaining access to the App.

If you try access the app before Trusting us the following message will appear.

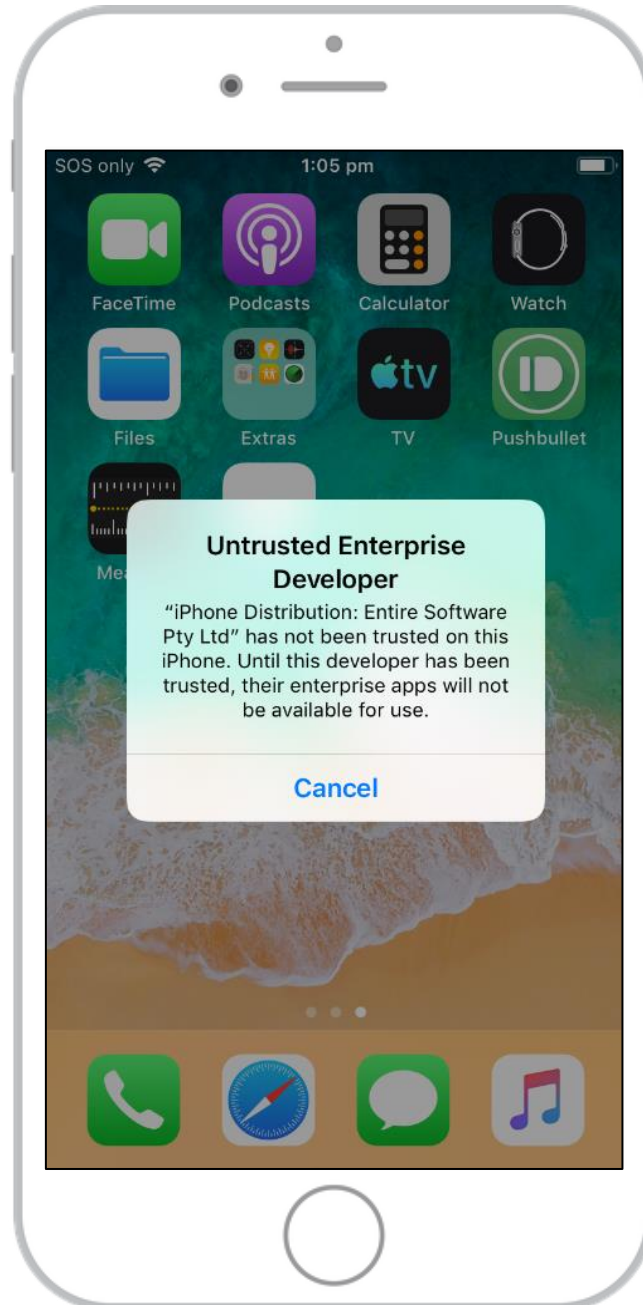

This is an added security measure from Apple to keep you phone safe from the Bad Guys.

5. Access Device Settings

Access your devices settings to trust the Enterprise developer.

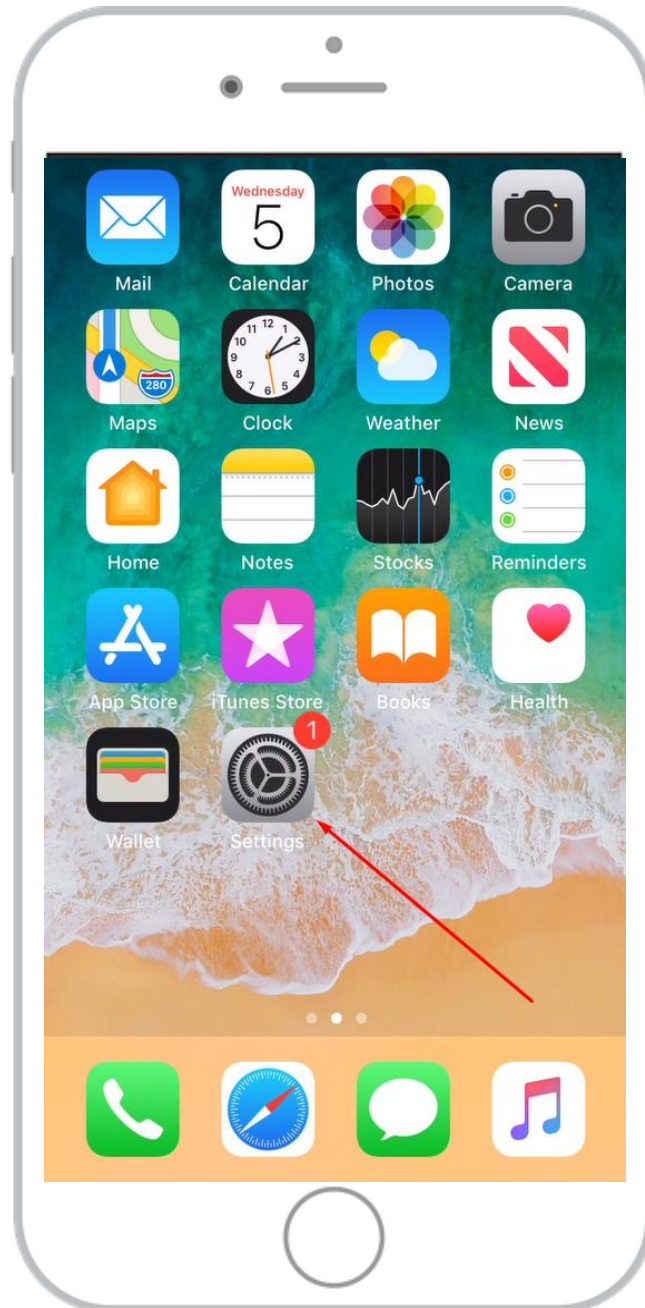

6. Select General

In your device settings scroll down and select General

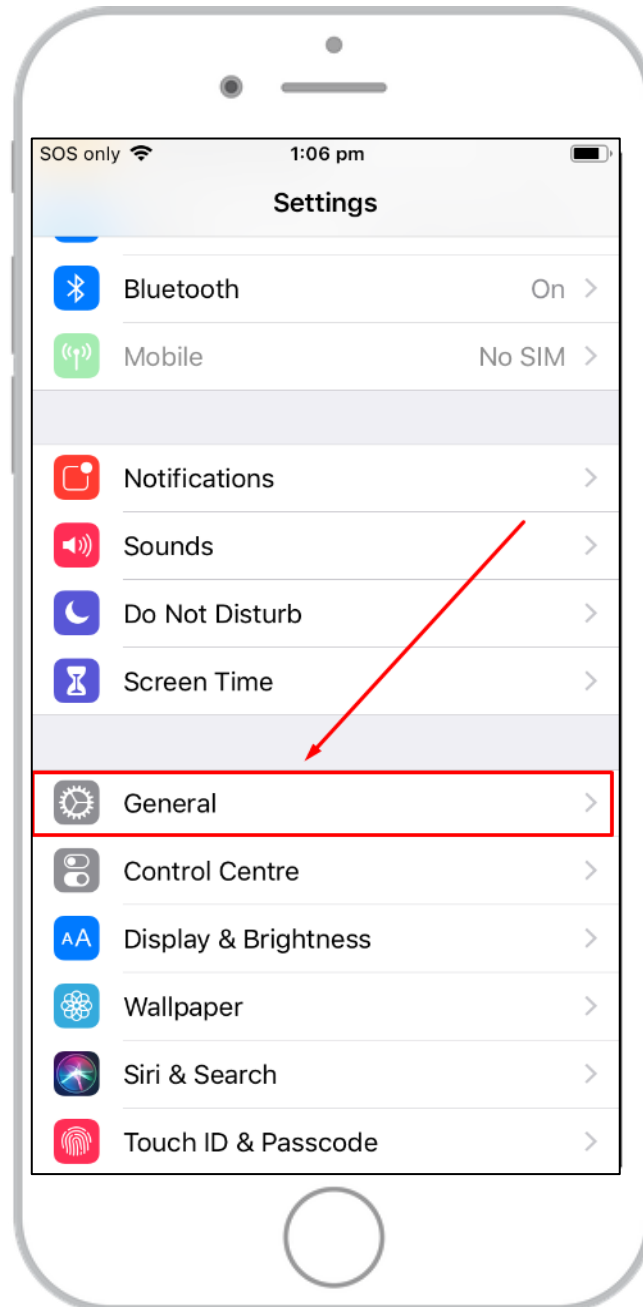

7. Select Device Management

Scroll down and select Device Management

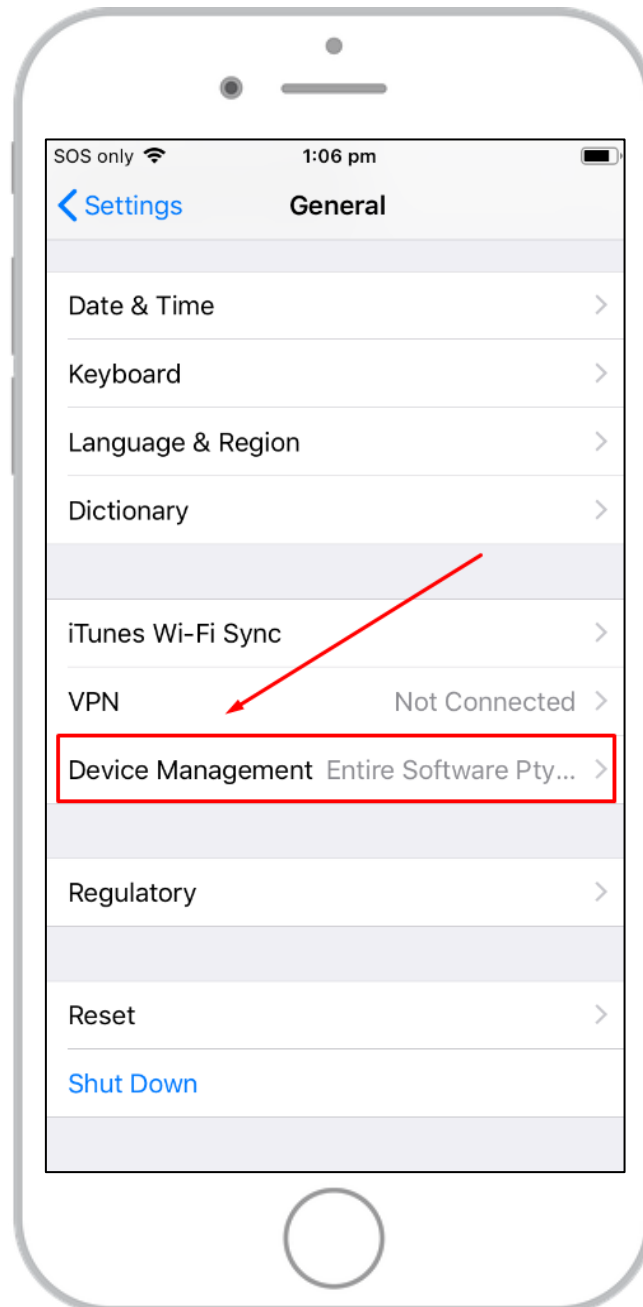

8. Click Entire Software Pty Ltd

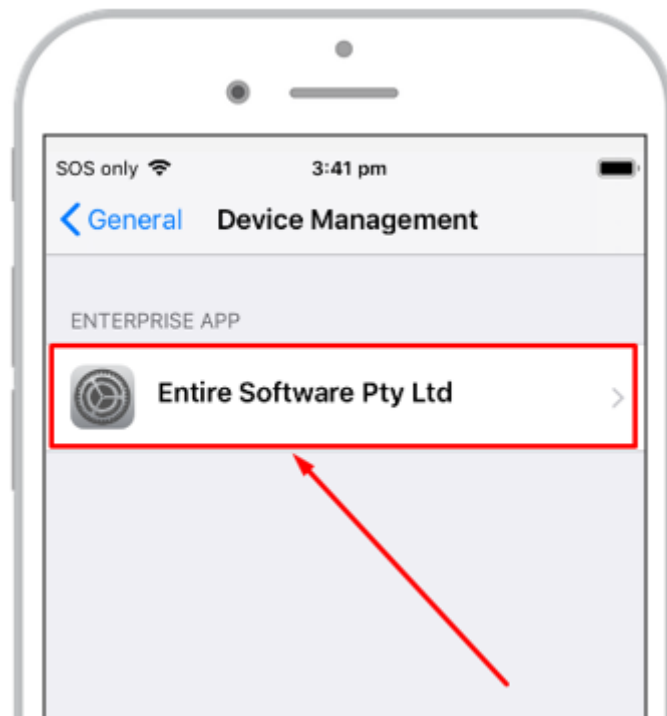

9. Final Step Trust "Entire Software Pty Ltd"

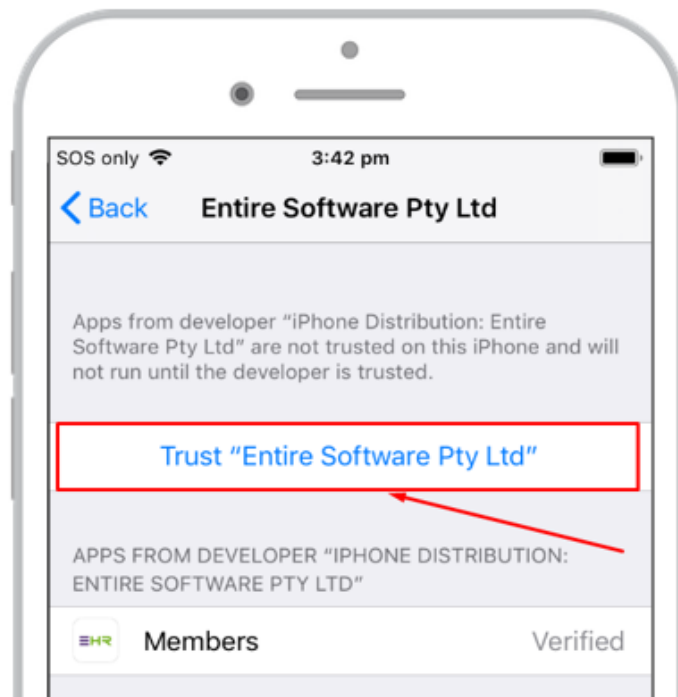

Now that we have gained your trust you can head back over and open the App.

When you first access the App you will need to enter you Member ID and Password.

If you don't know your ID and Password please contact the agency.

